

GRIPPERS WITH 3 PARALLEL JAWS – SERIES P11

Double-acting grippers with three self-centring jaws, internal and external clamping. The body contains slots for mounting retracting magnetic sensors.



TECHNICAL FEATURES	P11 - 16	P11 - 20	P11 - 25	P11 - 40	P11 - 60	P11 - 80
Min./max. operating pressure	bar					
Temperature range	1.5÷7					
Fluid	°C					
Size	20µm dried and lubricated filtered air. Lubrication, if used, must be continuous.					
Bore	16	20	25	40	60	80
Single jaw stroke	3	4	5	8	12.5	15
Closing force at 6 bar	58	90	150	390	880	1500
Opening force at 6 bar	65	108	170	450	1000	1700
Weight	0.12	0.21	0.3	1.2	2.7	4.5
Maximum operating frequency	1.5	1.5	1.5	1.2	1.2	1.2

NOTES

DIMENSIONS OF GRIPPER WITH 3 JAWS – SERIES P11 - 16

ORDERING CODES

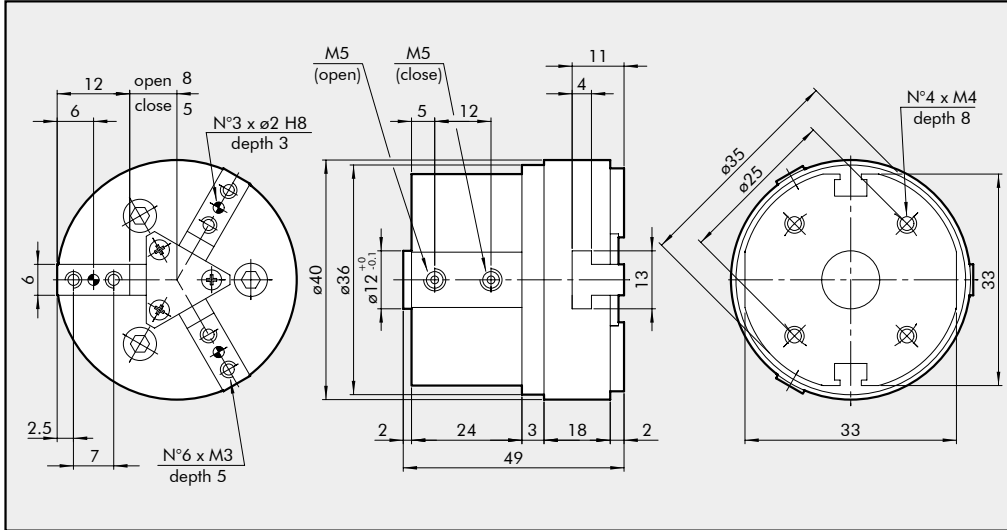

Code	Description
W1570160300	GRIPPERS WITH 3 PARALLEL JAWS P11-16

DIMENSIONS OF GRIPPER WITH 3 JAWS – SERIES P11 - 20

ORDERING CODES

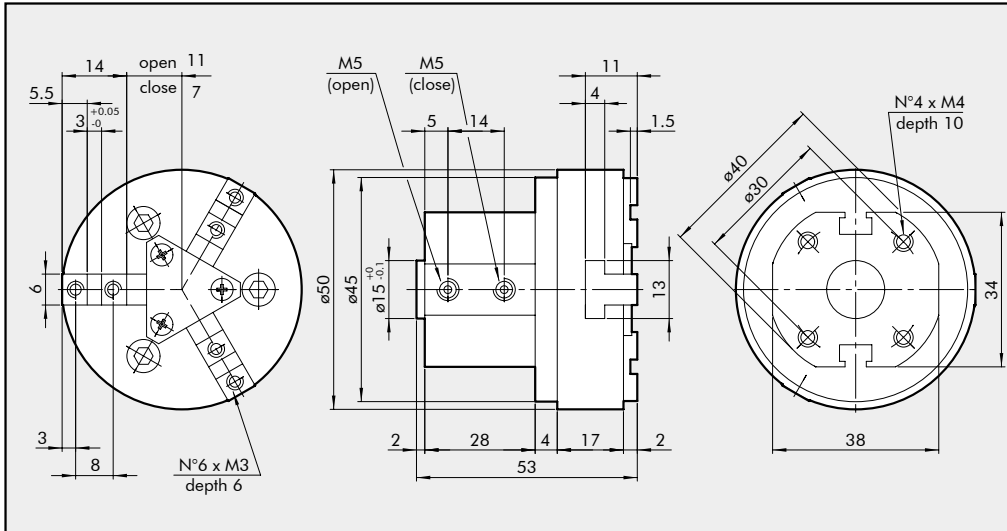

Code	Description
W1570200300	GRIPPERS WITH 3 PARALLEL JAWS P11-20

DIMENSIONS OF GRIPPER WITH 3 JAWS – SERIES P11 - 25

ORDERING CODES

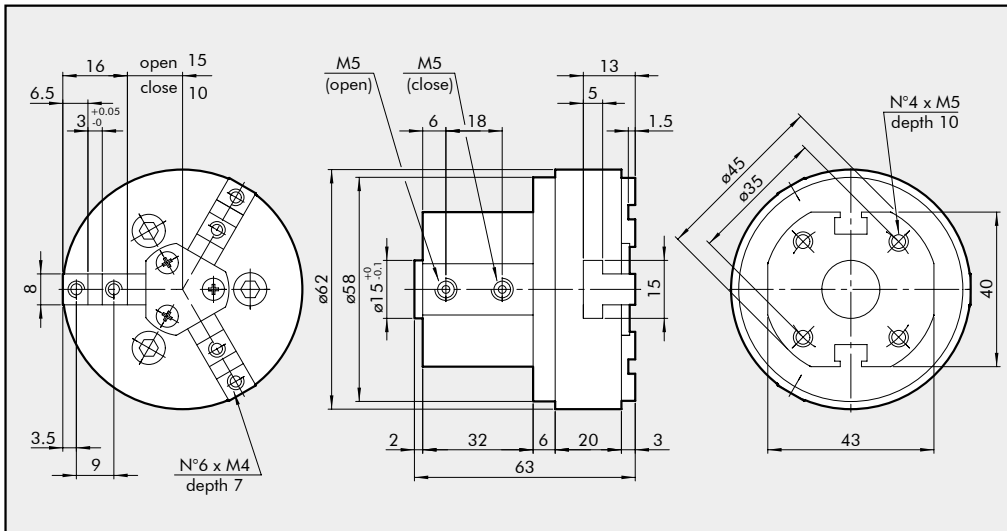

Code	Description
W1570250300	GRIPPERS WITH 3 PARALLEL JAWS P11-25

DIMENSIONS OF GRIPPER WITH 3 JAWS – SERIES P11 - 40

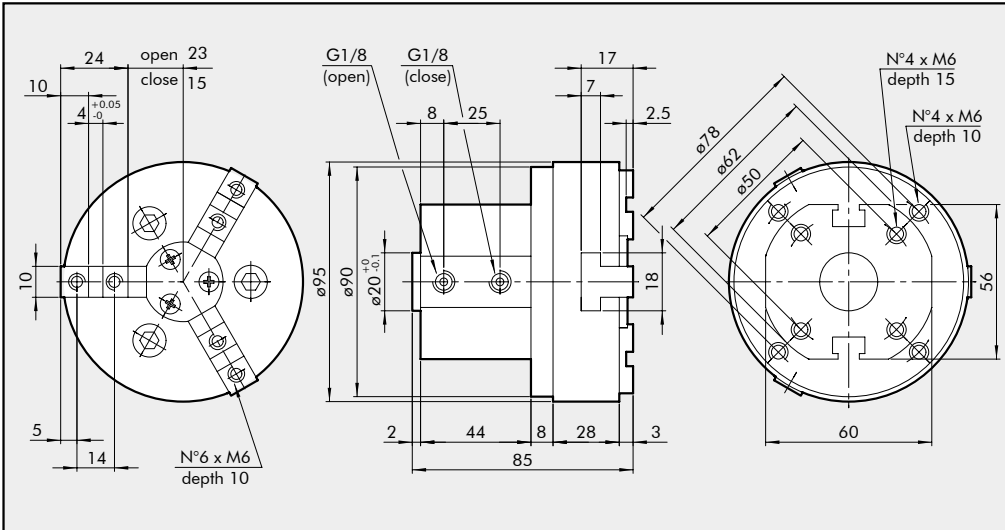

ORDERING CODES

Code	Description
W1570400300	GRIPPERS WITH 3 PARALLEL JAWS P11-40

DIMENSIONS OF GRIPPER WITH 3 JAWS – SERIES P11 - 60

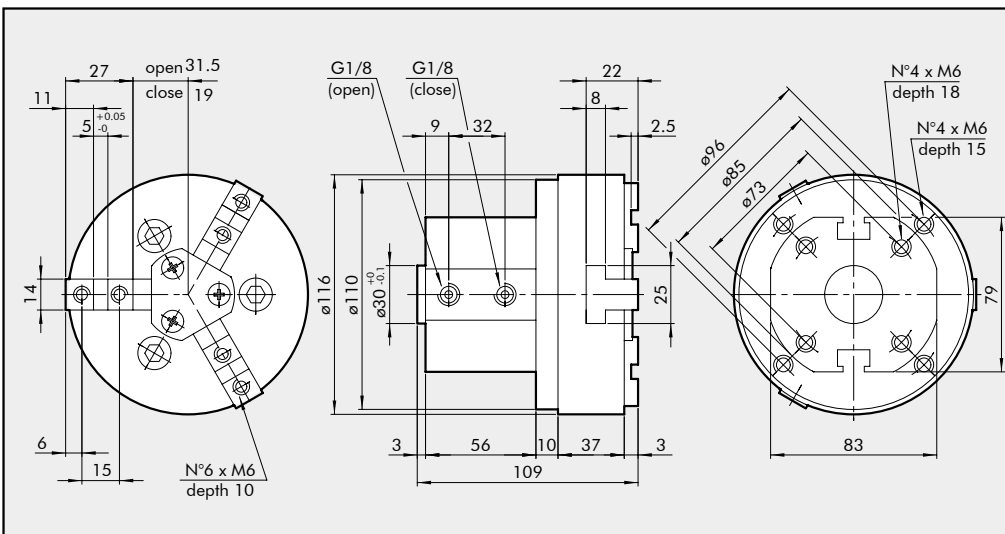

ORDERING CODES

Code	Description
W1570600300	GRIPPERS WITH 3 PARALLEL JAWS P11-60

DIMENSIONS OF GRIPPER WITH 3 JAWS – SERIES P11 - 80

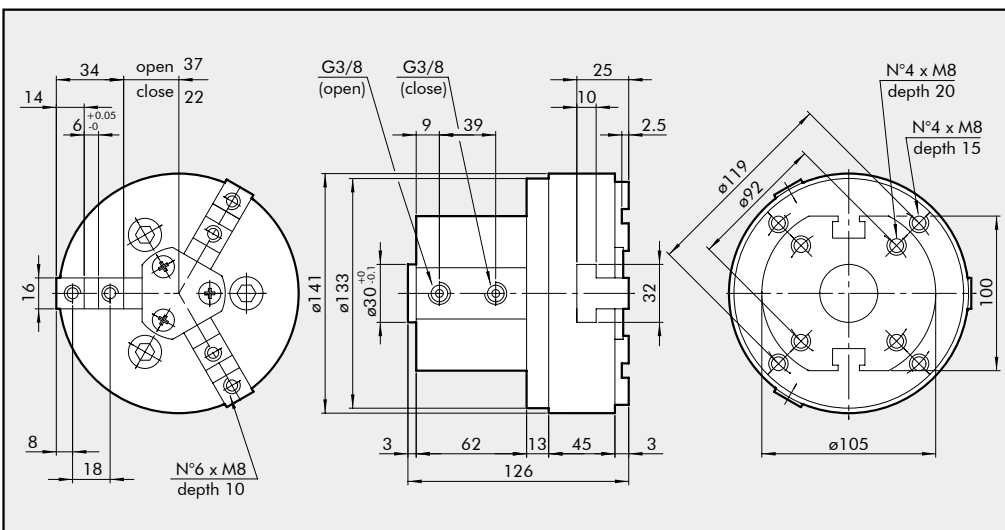

ORDERING CODES

Code	Description
W1570800300	GRIPPERS WITH 3 PARALLEL JAWS P11-80

ACCESSORI

RETRACTING SENSOR

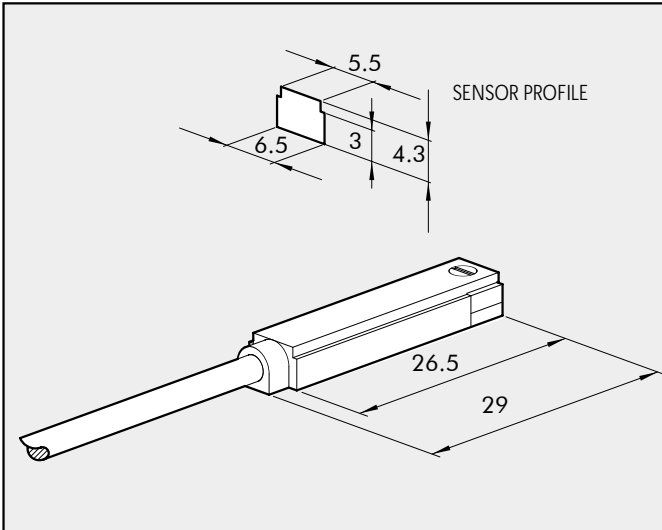

Code	Description
W0950025390	Hall sensor DSL, 3 wires, NO 2.5 m
W0950029394	Hall sensor DSL, 3 wires, NO 300 mm M8
W0950022180	Hall sensor DSL, 2 wires, NO 2.5 m
W0950028184	Hall sensor DSL, 2 wires, NO 300 mm M8

WIRING DIAGRAM

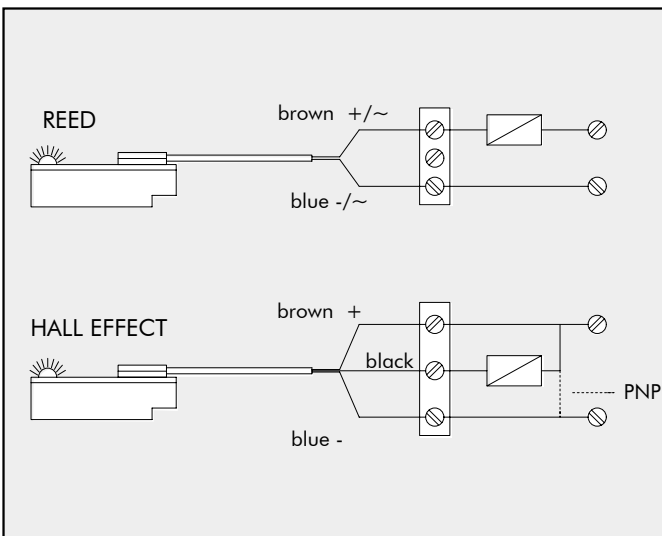

TECHNICAL FEATURES

		Reed	Effetto Hall
Type of contact		N.O.	N.O.
Switch		-	PNP
DC voltage range	V	3÷30	6÷30
AC voltage range	V	3÷30	-
Absorption	A	0.1	0.2
DC power	W	6	4
AC power	VA	6	-
Temperature range	°C	-20°C to +85°C	
Activation time	s	0.5µs	0.8µs
De-activation time	s	0.1µs	0.3µs
Life	imp	10 million	10 ⁹ million
Contact resistance	Ω	0.1	-
Degree of protection	IP	65	
Voltage drop	V	3	1
Number of wires		2	3

NOTES