

GRIPPER WITH 2 PARALLEL JAWS SERIES P1

- with or without magnet
- version with parallel opening and elliptical piston
- dual-acting system with gripping in both stroke directions.



TECHNICAL DATA		P1-16	P1-20	P1-32
Gaskets		NBR		
Operating pressure		1-8 bar (0.1 - 0.8 Mpa)		
Temperature range	°C	-10 to +80		
Fluid		Filter lubricated or lubricated air. Lubrication, if used, must be continuous.		
Bores	mm	16 - 20 - 32		
On request		Magnetic Version		
Average clamping force (at 6 bar)	N	8	15	35
Single jaw stroke	mm	4	5	6.5
Weight	Kg	0.32	0.55	1.37

DIMENSIONS OF GRIPPERS P1-16

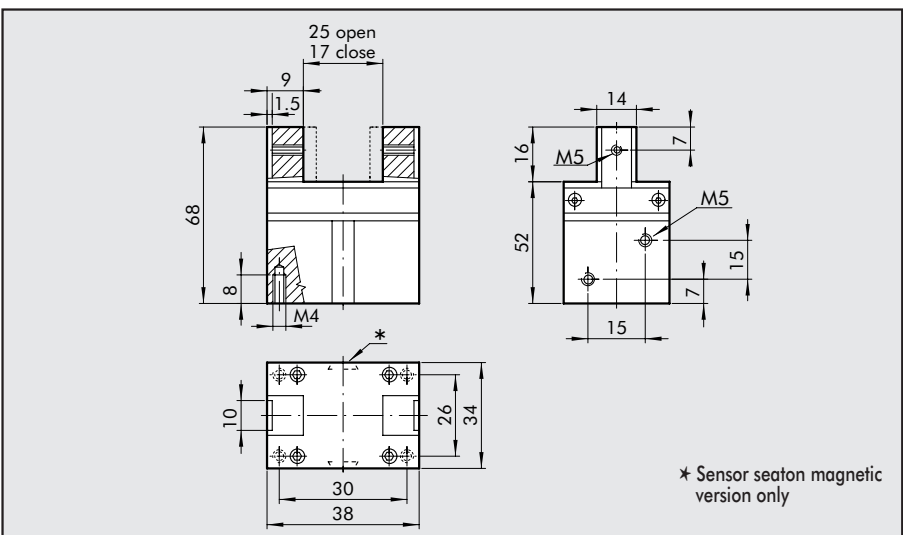

ORDERING CODES

Code	Description
W1540160000	GRIPPER PRL.GR-016-000
W1550160000	GRIPPER PRL.GR-016-000-MAGN



DIMENSIONS OF GRIPPERS P1-20

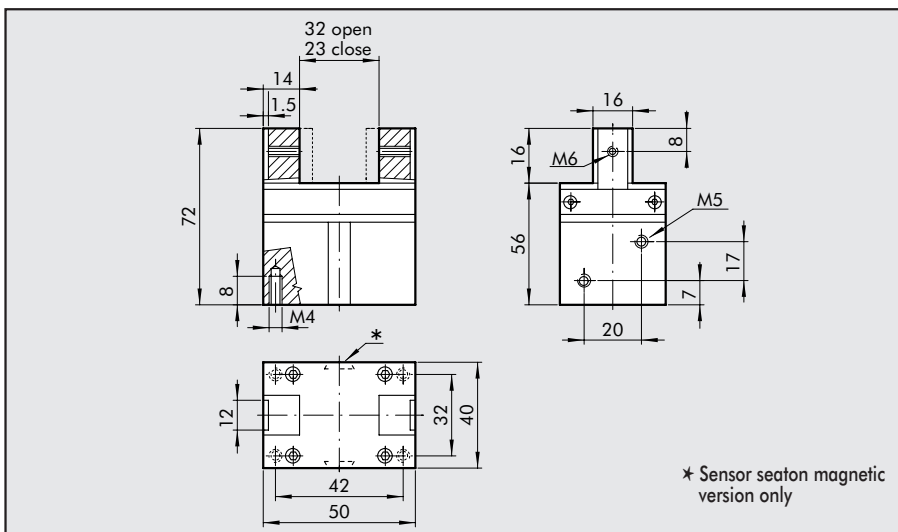

ORDERING CODES

Code	Description
W154020000	GRIPPER PRL.GR-020-000
W155020000	GRIPPER PRL.GR-020-000-MAGN

DIMENSIONS OF GRIPPERS P1-32

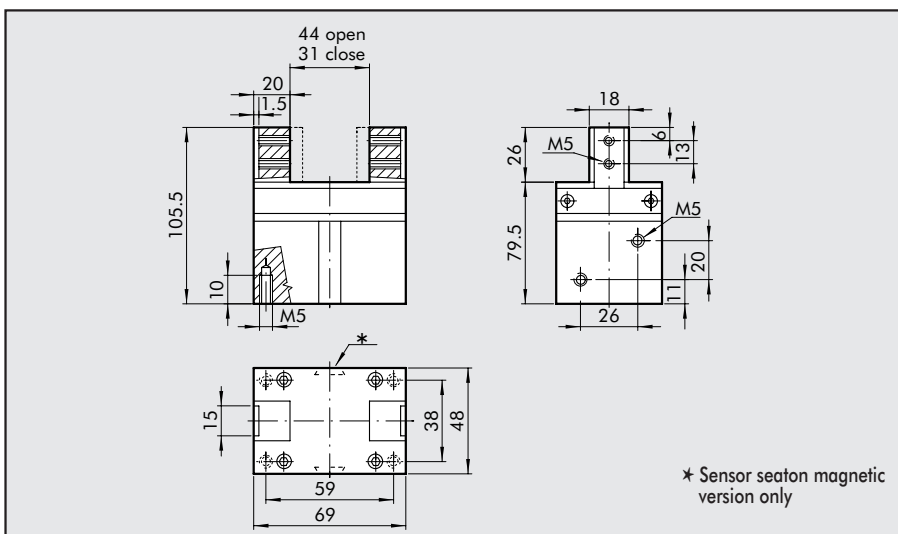

ORDERING CODES

Code	Description
W1540320000	GRIPPER PRL.GR-032-000
W1550320000	GRIPPER PRL.GR-032-000-MAGN

ACCESSORIES: MAGNETIC SENSORS

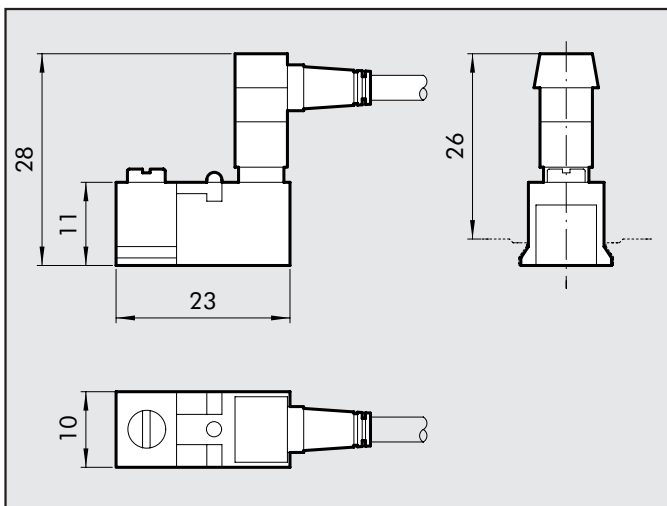

ORDERING CODES

Code	Description	Sigla
W0950000252	Reed connector + bracket - CB	REED SENSOR DCB 2C-425
W0950000253	Hall PNP connector + bracket - CB	E. HALL PNP SENSOR DCB3-N225

N.B.: For technical features of sensor, see accessories for SSCY cylinder, page 1.1/32